

SYJ-RH for R32 SERIES

SIGHT GLASS

Sight glasses are installed after the filter drier in liquid line of refrigerating systems, in order to observe property changes of the refrigerant (liquid/vapor) and to indicate the moisture level by colors.



FEATURES

- HIGH PRECISION COLOR INDICATOR
- INDICATOR PASTED CLOSELY TO THE GLASS TO PREVENT SURFACE CONTAMINATION
- SOLID AND CORROSION RESISTANT BRASS MATERIAL
- GOOD READABILITY DUE TO HIGH CLEAR SIGHT GLASS OF WIDE ANGLE
- SEALING OF LOW CREEP PTFE TO ENSURE LEAKAGE FREE PERFORMANCE
- NEW ANNULAR HUMIDITY COLOR INDICATOR. FULL PORT PASSAGE WITH LOW PRESSURE DROP

GENERAL SPECIFICATION

- Applicable for refrigerants such as R32
- Ambient temperature min./max.: -50°C / +80°C
- Medium temperature TS min./max.: -50°C / +80°C
- Max. operating pressure PS: 4,9 MPa (49 bar)
- Installation position:
 - Liquid and suction line
 - Preferably in vertical lines, recommended position for horizontal
Lines are upwards without inclination in any direction
- Declaration according to PED (all products have been covered by Art.4.3 PED Directive 2014/68/EU)

SIGHT GLASS



Version with Solder Connections, MOP 49 bar

General Characteristics										
Model Series	Model Name	Part Number (multi package) ¹⁾	Connection Type	Connections ODF		Dimensions & Weight				
				Ød		L	H	H1	Weight	Drawing
				[inch]	[mm]	[mm]	[mm]	[mm]	[g]	
SYJ6	SYJ06RH12	10285011502	ODF x ODF solder	-	6	101	24	14	100	A
SYJ6	SYJ06RH11	10285011402		1/4	-	101	24	14	100	
SYJ10	SYJ10RH11	10285011602		3/8	-	119	24	14	100	
SYJ10	SYJ10RH12	10285011702		-	10	119	24	14	100	
SYJ12	SYJ12RH11	10285012302		1/2	-	146	30	17	200	
SYJ12	SYJ12RH12	10285011802		-	12	146	30	17	200	
SYJ16	SYJ16RH11	10285011902		5/8	16	146	30	17	200	
SYJ19	SYJ19RH11	10285012002		3/4	-	173	37	21	300	
SYJ22	SYJ22RH11	10285012102		7/8	22	173	37	21	300	
SYJ28	SYJ28RH11	10285012202		1 1/8	28	173	37	21	300	

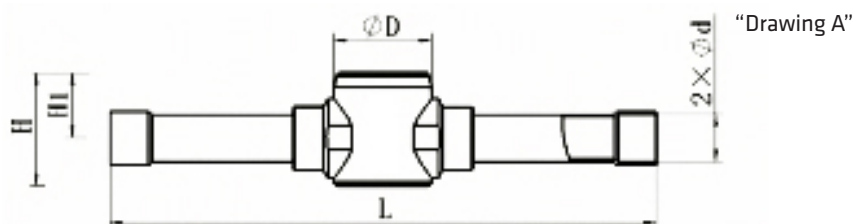

Moisture Indication Limits

Refrigerant	Moisture Content 25°C: PPM		
	Green/Dry	Middle Color	Yellow/Wet
R32	<120	120~380	>380

Refrigerant	Moisture Content 40°C: PPM		
	Green/Dry	Middle Color	Yellow/Wet
R32	<200	200~580	>580